

ASSEMBLY # 1 - Mission 8 Drawer

61 x 37 1/4 x 18 1/4 ( 1 )

(2)	DOORS	18 1/4	37 1/4	Mission Sq. End	Quarter Sawn
<b>DRAWERS</b>					
(2)	28	4 7/8		Flat	Q.Sawn Drawer
(2)	28	7 3/8		Flat	Q.Sawn Drawer
(4)	28	8 5/8		Flat	Q.Sawn Drawer
<b>FRAME</b>					
(1)	3	57 1/2		Bottom Rail	Quarter Sawn Oak
(1)	1 3/4	37 1/4		Right Stile	Quarter Sawn Oak
(1)	1 1/4	57 1/2		Top Rail	Quarter Sawn Oak
(1)	1 3/4	37 1/4		Left Stile	Quarter Sawn Oak
(1)	1 1/4	33		Mid Stile	Quarter Sawn Oak
(6)	1	28 1/8		Mid Rail	Quarter Sawn Oak
<b>PANEL STOCK</b>					
(1)	59 7/8	35		Unfinished Back	1/4 Birch Ply GS1
(2)	2 1/4	59 7/8		Top Stretcher	3/4 Birch Ply A1
(1)	17 1/4	59 7/8		Deck	3/4 Birch Ply A1
(8)	26 7/8	14 1/4		Drawer Box Bottom	Draw 1/4 Birch Ply
<b>BOARD STOCK</b>					
(1)	18 3/4	62		Mission Top	1" Quartersawn Oak
(4)	4	14 1/2		Drawer Box Side	5/8 Oak
(2)	4 1/8	27 3/4		Drawer Box Back	5/8 Oak
(2)	4 1/8	27 3/4		Drawer Box Sub Front	5/8 Oak
(4)	6	14 1/2		Drawer Box Side	5/8 Oak
(2)	6 1/8	27 3/4		Drawer Box Back	5/8 Oak
(2)	6 1/8	27 3/4		Drawer Box Sub Front	5/8 Oak
(8)	7	14 1/2		Drawer Box Side	5/8 Oak
(4)	7 1/8	27 3/4		Drawer Box Back	5/8 Oak
(4)	7 1/8	27 3/4		Drawer Box Sub Front	5/8 Oak
<b>HARDWARE</b>					
(16)	1	15		Drawer Guide	Tandem 5/8 15"
(16)	1	3		Drawer Pull	Mission Drawer Pull

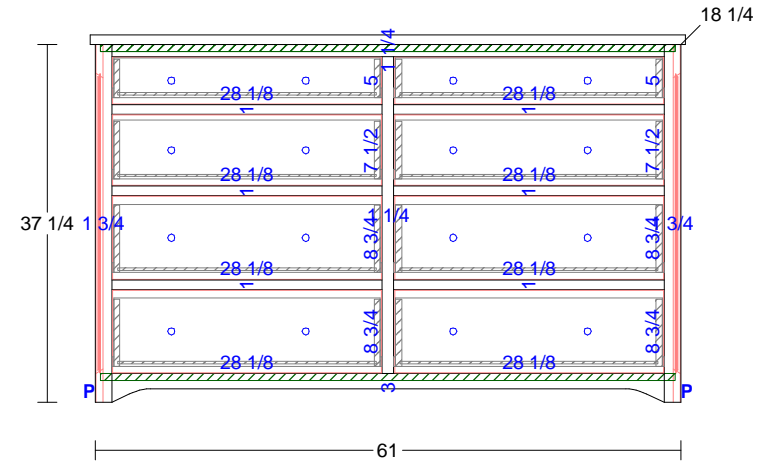

ASSEMBLY # 1 - Mission 8 Drawer

L.Stile = 1 3/4	L.Scribe = 1/16	R.Stile = 1 3/4	R.Scribe = 1/16
T.Scribe = 0	B.Scribe = 2 1/4		
Left End = Panelized	Right End = Panelized	Back = Unfinished	
Toe Height = 0	Toe Recess = 0		

Ideas In Wood

Job

Default

Room # 1 (Q Sawn Room) - Wall # 1

Date : 10-24-2008